

# SPECIFICATION FOR APPROVAL

## 规 格 书

Customer (客户): \_\_\_\_\_

Customer part No: \_\_\_\_\_  
(客户型号)

Our part No : JMS2340IW-08R-8Ω0.5W  
(本厂型号)

Sample No : \_\_\_\_\_  
(样品编号)

Date (日期) : 2018-01-03

Environment Request: (环境标准)

NON-ROHS (非 ROHS 标准)     ROHS (ROHS 标准)

OTHERS (其它) : \_\_\_\_\_

### CUSTOMER'S APPROVED SIGNATURE



常州市杰之美电声器材有限公司

CHANGZHOU JIEZHIMEI ELECTROACOUSTIC EQUIPMENT CO., LTD.

Adds: 常州市武进区坂上工业区殷家塘 35 号

Tel: +86-519-8129 8007

Fax: +86-519-8129 9007

[Http://www.jm-speaker.com](http://www.jm-speaker.com)

E-mail: jiezhimei@188.com

|           | DESIGNED | CHECKED | APPROVED     |
|-----------|----------|---------|--------------|
| SIGNATURE | yliang   | yliang  | Samsoon Duan |



## Loud Speaker Specification

| No. | Item<br>项目                       | Specification<br>规格                                    | Testing Condition<br>测试条件                          |
|-----|----------------------------------|--|--|
| 1.  | Rated Imp<br>共称阻抗                | 8 Ω ± 15%  | At 1 kHz 1.0 Vrms                                  |
| 2.  | Resonance Freq<br>最低共振周波数        | 800Hz ± 20%  | Without Baffle                                     |
| 3.  | Output S.P.L.<br>出力音压            | 89 ± 3dB   | At 0.1m 0.1W 800,1K,1.2K,1.5KHz<br>Average         |
| 4.  | Rated Power<br>定格入力              | 0.5 W  |  |
| 5.  | Max Power<br>最大入力                | 1.0 W  |  |
| 6.  | Frequency Range<br>实效频宽          | F0----8K Hz  | Output S.P.L. -10dB                                |
| 7.  | Operation<br>可靠性试验               | Must Be Normal   | Program Source Rated Power                         |
| 8.  | Buzzes & Rattles<br>异常音试验        | Should not be audible buzz<br>and rattle<br>无异常声       | Sine Wave Between (正弦波入力)<br>at 2Vrms / F0----8KHz |
| 9.  | Distortion<br>失真                 | 10% Max  | 0.1W Input 1000Hz                                  |
| 10. | Magnet<br>磁铁                     | Size: Φ8.0*1.0 mm N35<br>Flux Density: ----- Gauss(高斯) |  |
| 11. | Operating<br>Temperature<br>工作温度 | -20°C to +60°C   |  |
| 12. | Storage<br>Temperature<br>储存温度   | -30°C to +70°C   |  |
| 13. | Weight<br>重量                     | ~5g/PCS  |  |

|     |   |  |
|-----|---|--|
| 14. | Cold Test<br>耐寒试验                               | After having been in a test chamber for 96 hours at the condition of $-20^{\circ}\text{C}\sim 2^{\circ}\text{C}$ and then left 2 hours in a room.<br>( $-20^{\circ}\text{C}\sim 2^{\circ}\text{C}$ , 96 小时试验室温两小时后, 无异常)                         |
| 15. | Heat Test<br>耐热试验                               | After having been in a test chamber for 96 hours at the condition of $+60^{\circ}\text{C}\sim 2^{\circ}\text{C}$ 90~95% R.H and then left 2 hours in a room. ( $+60^{\circ}\text{C}\sim 2^{\circ}\text{C}$ 90~95% R.H) 96 小时试验常温 2 小时后, 无异常的(不良) |
| 16. | Load Test<br>连续负荷试验                             | Must be normal after load test :white noise Rated Power 96 hours.<br>(白噪音定格输入连续 96 小时试验后无异常的(不良))  |
| 17  | Short Term<br>Maximum Power<br>test<br>瞬间最大功率测试 | Test for 1 hour under maximum power. Input shall be white noise in rated frequency response. And the signal will be 1 second on, 59 seconds off, total 60 cycles.<br>(白噪音最大输入, 1 秒开 59 秒关, 连续 60 循环, 试验后无异常之(不良))                                |
| 18. | Polarity<br>极性                                  | When a positive D.C current is applied to the voice terminal marked + or white, the diaphragm shall move forward<br>(端子的正极输入电流, 振动板向前方向运动)   |
| 19. | Drop Test<br>跌落试验                               | Drop the speakers contained in normal box onto a board 5mm thick 10 times from a height of 1.0m .<br>(在厚 5mm 的木板上从 1.0m 的高度跌落 10 次, 无异常(不良))   |
| 20. | Terminal strength<br>端子强度                       | A static load of 5.0N shall be applied to the terminals for 10s in any direction between terminal block and frame and between terminal block and fasten terminal.<br>(端子板和支架或焊片任一方向上 5.0N 的力 10s 无异常)  |

### Temperature Cycle Test(5 cycle)

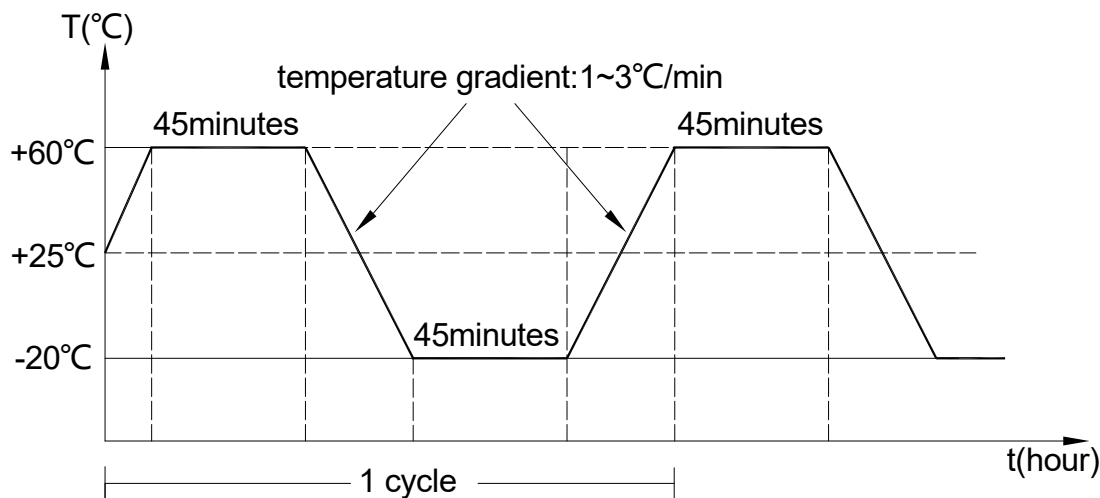

## Frequency Response

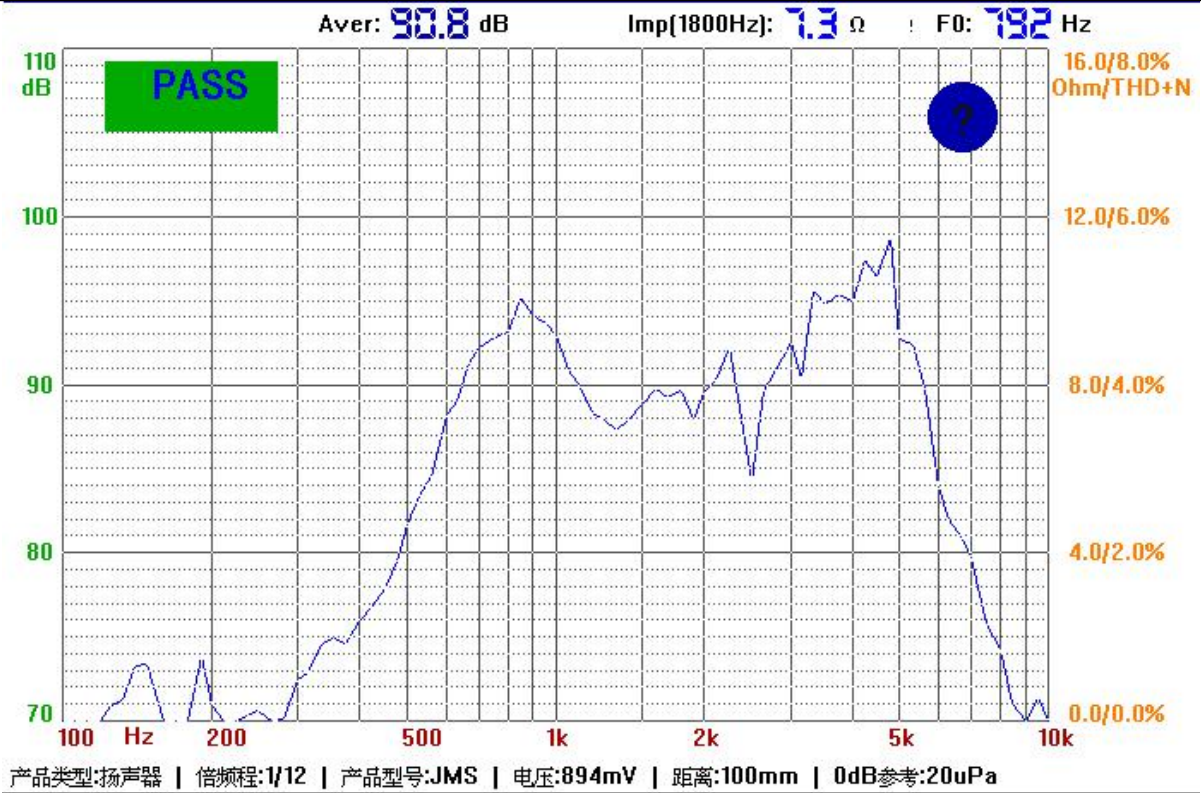

### MEASUREMENT CIRCUIT

#### Standard test condition of speaker

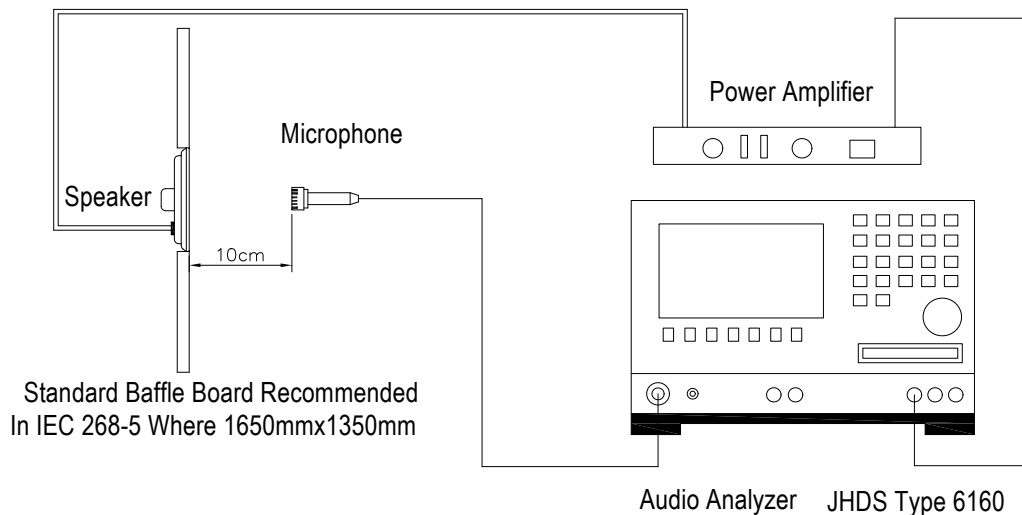

Product Outside View

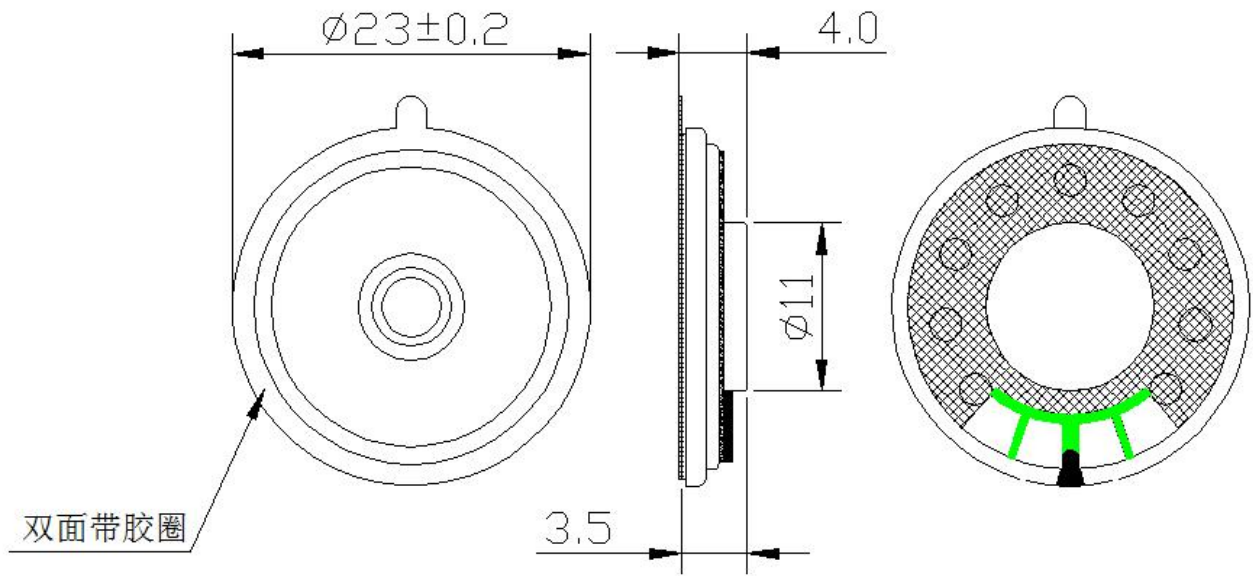

NOTE:  $\pm 0.5$

Unit: mm

Noise Testing

Product Photos 产品照片

Positive  
正面

Back  
背面

